

# 300 Industrial Road Ridgefield Park, NJ

# AVAILABLE

For additional information,  
please contact:

**William R. Waxman**

201.712.5810

william.waxman@cbre.com

**Gary E. Capetta**

201.712.5879

gary.capetta@cbre.com

**Nicholas J. Nitti**

201.712.5827

nicholas.nitti@cbre.com

**Carrie Brown**

201.712.5809

carrie.brown@cbre.com

**Justin Stein**

201.712.5615

justin.stein@cbre.com

CB Richard Ellis  
Park 80 West Plaza Two  
Saddle Brook, NJ 07663  
main: 201.712.5600  
fax: 201.712.5885

[www.cbre.com](http://www.cbre.com)

**CBRE**  
CB RICHARD ELLIS

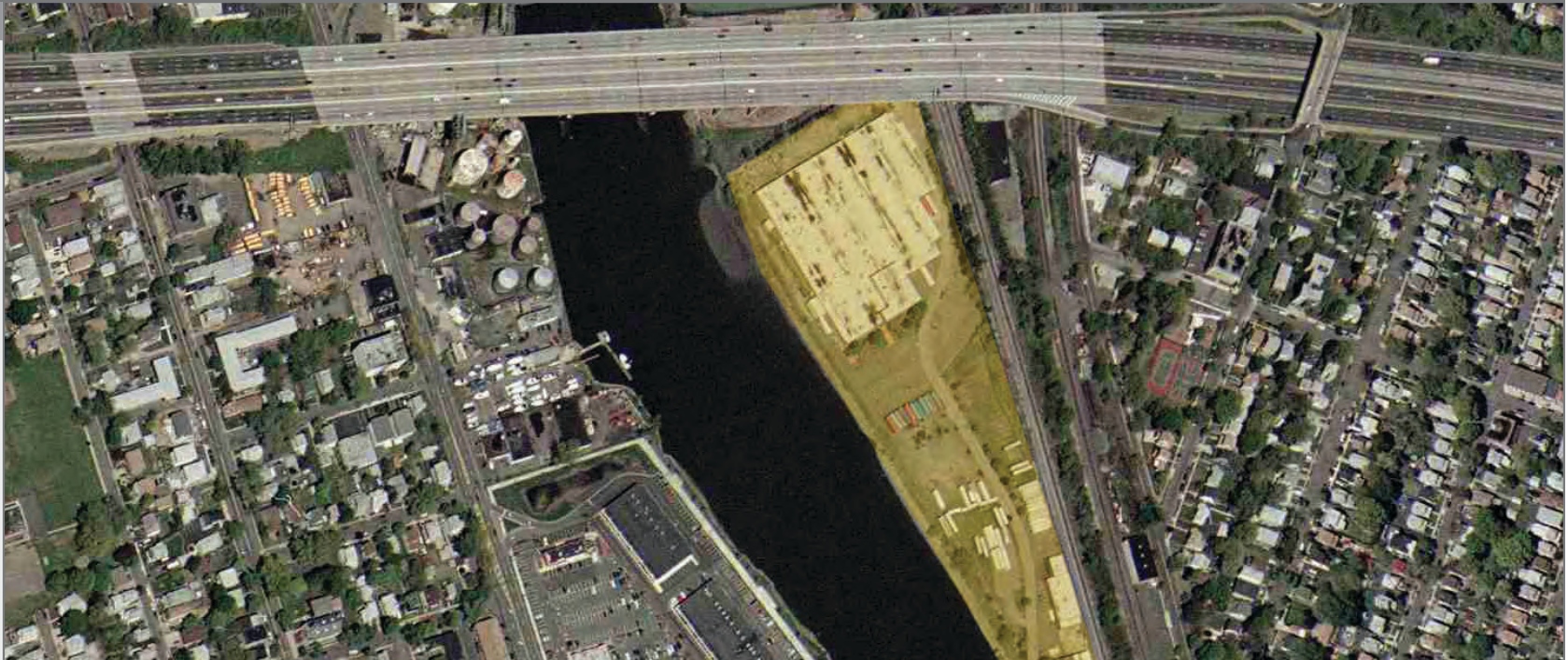

CB Richard Ellis, Inc., as exclusive agent, is pleased to offer the following prime space for sale:

**BUILDING SIZE:** 153,000 sq. ft.  
**PLOT SIZE:** 11 acres  
**OFFICE SIZE:** 8,000 sq. ft.  
**CEILING HEIGHT:** 16'  
**LOADING:** 14 tailboards  
1 drive in  
**COLUMN SPAN:** 33'6" x 33'6"  
**SPRINKLER:** Wet  
**HEAT:** Gas

**POWER:** 1000 amps  
**PARKING:** 150± cars  
**SALE PRICE:** \$12,000,000  
**TAXES:** \$0.93 per sq. ft.  
**ZONING:** Heavy Industrial  
**POSSESSION:** Immediate  
**COMMENTS:** Outside storage permitted

# 300 Industrial Road Ridgefield Park, NJ

# AVAILABLE

For additional information,  
please contact:

**William R. Waxman**  
201.712.5810

[william.waxman@cbre.com](mailto:william.waxman@cbre.com)

**Gary E. Capetta**  
201.712.5879

[gary.capetta@cbre.com](mailto:gary.capetta@cbre.com)

**Nicholas J. Nitti**  
201.712.5827

[nicholas.nitti@cbre.com](mailto:nicholas.nitti@cbre.com)

**Carrie Brown**  
201.712.5809

[carrie.brown@cbre.com](mailto:carrie.brown@cbre.com)

**Justin Stein**  
201.712.5615

[justin.stein@cbre.com](mailto:justin.stein@cbre.com)

CB Richard Ellis  
Park 80 West Plaza Two  
Saddle Brook, NJ 07663  
main: 201.712.5600  
fax: 201.712.5885

[www.cbre.com](http://www.cbre.com)

**CBRE**  
CB RICHARD ELLIS

### HIGHLIGHTED AERIAL



### LOCATION MAP



### SITE PLAN

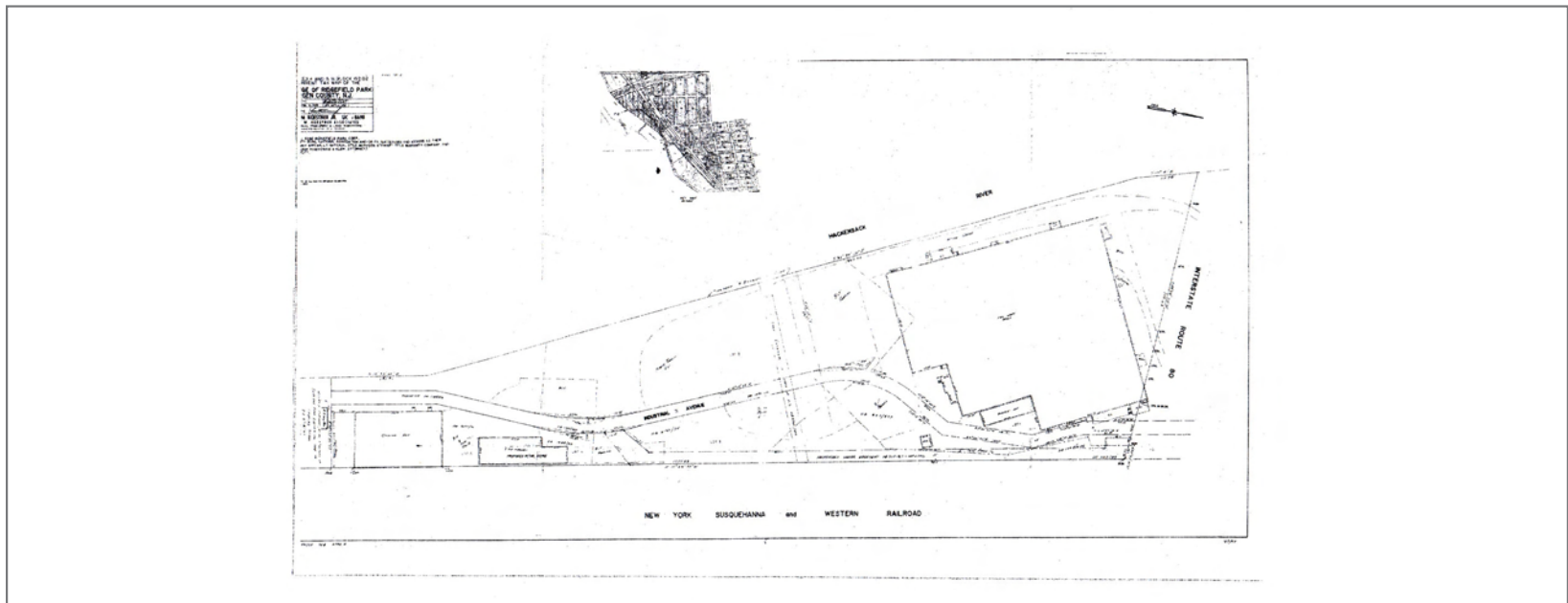

©2004 CB Richard Ellis Inc. The information above has been obtained from sources believed reliable. While we do not doubt its accuracy, we have not verified it and make no guarantee, warranty or representation about it. It is your responsibility to independently confirm its accuracy and completeness. Any projections, opinions, assumptions or estimates used are for example only and do not represent the current or future performance of the property. The value of this transaction to you depends on tax and other factors which should be evaluated by your tax, financial and legal advisors. You and your advisors should conduct a careful, independent investigation of the property to determine to your satisfaction the suitability of the property for your needs. CB Richard Ellis.